

CP – Cross-Pack Service Boxes – Steel & Aluminum – Both End Double Side Open Doors

Cross-pack service boxes are heavy duty, high capacity and offer easy access to your equipment. Boxes are mounted behind truck cab on truck frame. These boxes are perfect for storing your equipment, tools and personal gear. Cross-pack boxes are available in different sizes and can be ordered custom size. All AMERICAN TRUCKBOXES boxes are designed and built to keep your equipment safe and secure.

Description

- An engineered steel or aluminum construction
- Fully seam welded on all seams and corners
- Stainless steel continuous hinge on full length of door
- Channel braced reinforced door with gas springs
- Lockable SS Dolphin Tail HD adjustable T-handle latch
- Built-in frame mounting rails for easy installation
- Rain gutter and automotive type weather seal
- Stationary shelves and two J-hooks on either side
- Zinc epoxy primer with MR powder baked topcoat finish
- **Optional service boxes (see chart)**
- Mounting kit not included: Kit available M3450C



Shown with Optional Service Boxes

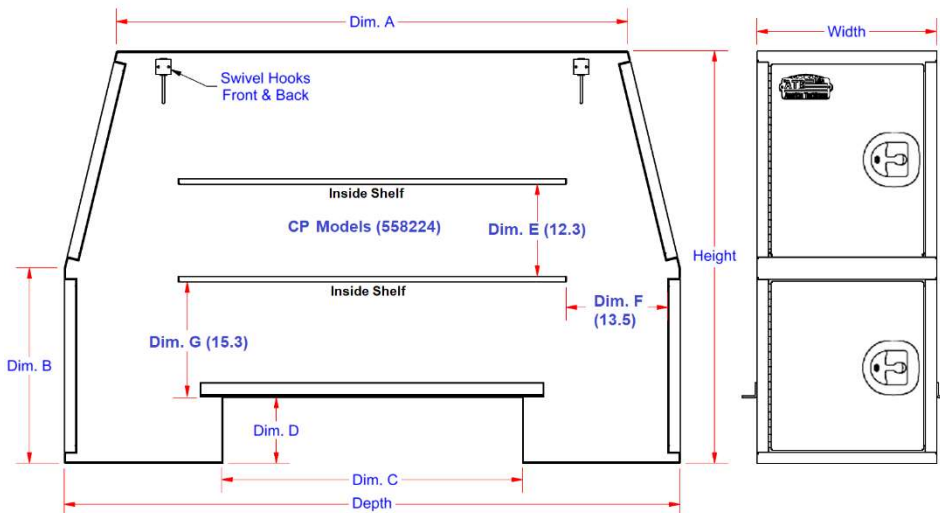

Note: *Boxes are available in: Black (B) and White (W) Finish – add after part number.

No.	Model Number	Material	Height (in.)	Depth (in.)	Width (in.)	Dim. A (In.)	Dim. B (in.)	Dim. C (in.)	Dim. D (in.)	Service Boxes (K)	Weight (lb.)
1.	A-CP51-558224-S	10g Aluminum	55	82	24	68	26	40	8.75	15x21x24-30	300
2.	A-CP51-558524-S	10g Aluminum	55	85	24	71	26	40	9.1	15x21x24-30	310
3.	A-CP51-559224-S	10g Aluminum	55	92	24	78	26	40	8.75	15x21x24-30	335
4.	A-CP51-589224-S	10g Aluminum	58	92	24	78	28	40	8.75	15x21x24-30	354
5.	A-CP51-628224-S	10g Aluminum	62	82	24	68	40	40	16.75	18x21x30-36	340
6.	A-CP51-658224-S	10g Aluminum	65	82	24	68	26	40	13.75	15x21-30-36	356
7.	A-CP51-708224-S	10g Aluminum	70	82	24	68	48	40	16.75	18x21x30-36	385
8.	S-CP41-558224-*	14g Steel	55	82	24	68	26	40	8.75	15x21x24-30	489
9.	S-CP41-558524-*	14/12g Steel	55	85	24	71	26	40	9.1	15x21x24-30	508
10.	S-CP41-559224-*	14/12g Steel	55	92	24	78	26	40	8.75	15x21x24-30	550
11.	S-CP41-589224-*	14/12g Steel	58	92	24	78	28	40	8.75	15x21x24-30	580
12.	S-CP41-628224-*	14/12g Steel	62	82	24	68	40	40	16.75	18x21x30-36	555
13.	S-CP41-658224-*	14/12g Steel	65	82	24	68	26	40	13.75	15x21-30-36	580
14.	S-CP41-708224-*	14/12g Steel	70	82	24	68	48	40	16.75	18x21x30-36	625